



Enhanced Living and Personal Care



Hyatt M. and Ida M. Cribbs Residential Center

31 N. Park Avenue • Meadville, PA 16335

814-332-9009 • Toll Free 1-877-937-2879

www.wesbury.com



For over 100 years, Wesbury has built a strong reputation for exceeding the expectations of the Continuing Care Retirement Community experience. As a Christian based, not-for-profit organization, Wesbury is committed to providing much more than a fine collection of programs and services - we are committed to providing an enriched way of life.

EAGLE Accredited

Wesbury has received EAGLE accreditation six consecutive times from The United Methodist Association of Health and Welfare Ministries (UMA), a national network of more than 400 health and welfare-related organizations. The Educational Assessment Guidelines Leading toward Excellence (EAGLE) accreditation is a quality enhancement program offered every five years to faith-based organizations providing care to older adults, children, youth and families. The intensive assessment and peer review process encourages and recognizes excellence in Christian mission and ministry. EAGLE accredited facilities are stringently reviewed based on their business practices and social principles as well as their Christian mission. EAGLE peer reviewers focus on an organization's relationships within its local community, on the persons being served, as well as governance and management.

Wesbury provides individualized proactive health care and life enrichment services to assist mature adults in maintaining their independence, dignity and spiritual wholeness in a secure, Christian environment.

- Mission Statement -

Enhanced Living and Personal Care at Wesbury

Cribbs Residential Center is specifically designed for those who desire to maintain independence, but may require some assistance with daily tasks, bridging the gap between residential living and nursing care.

The attentive staff provides all dining, laundry and housekeeping services as well as transportation, security and a variety of life enrichment and fitness programs. Through participation in the local community, as well as on campus events, residents may be as active or relaxed as they choose. Residents also find comfort in knowing that additional assistance is always available. Skilled caregivers, which include licensed nurses, are on-site 24 hours every day and can assist with a wide range of personal needs such as bathing, dressing, managing medications and medical care. As the burdens and chores of daily living are lifted, residents are free to enjoy life - with choice, dignity, privacy and security.

Community Amenities

- 110-acre private, beautifully landscaped campus
- Nearby golf courses, lakes, state parks and outdoor attractions
- Exercise room
- Wellness center
- Gift shop
- Dining options include the Neighborhood Grill Restaurant
- Library
- Free wireless internet
- Video conferencing using Skype technology
- Community room for entertainment, lectures and special events
- Beauty/barber shop
- Card rooms
- Craft/recreational room with billiards
- Two on-site Chapels
- Catered private dining room
- Guest house accommodations and parking
- Nature trail
- Picnic pavilion and gazebo
- Outdoor gardening areas
- Art studio
- Activities kitchen
- Wood shop
- On-site access to public transportation
- ATM
- Common kitchens and laundry room for personal use
- Medical Arts Building with on-site Geriatric Specialist



Rates and Information

The following rates and inclusions apply for temporary and long term accommodations.

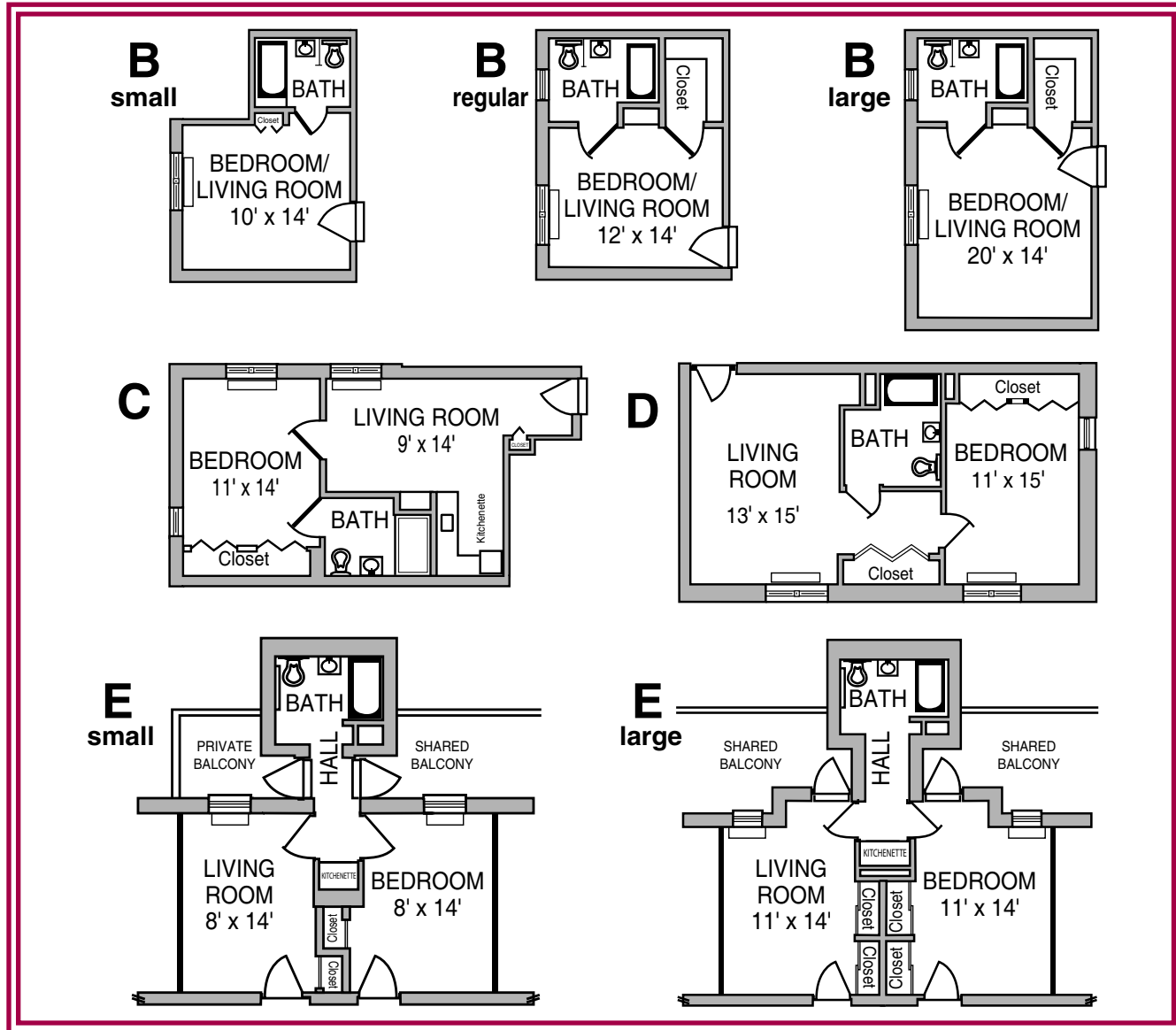

Wesbury offers a variety of floor plans designed to appeal to differing tastes and budgets. These accommodations await the personal touches and cherished belongings that truly make them home.

Basic monthly fees include:

- All meals are available in our dining room and The Neighborhood Grill
- Housekeeping services
- All utilities including telephone service
- Basic television cable service
- Free WiFi
- Complete interior and exterior maintenance
- Transportation for local medical appointments and shopping
- Linen and laundry service
- A full-time Chaplain offering spiritual programs and support
- Life enrichment and fitness programs
- Emergency response system
- Local ambulance membership
- Notary services
- Direct-dial smoke and fire system
- Access to all Wesbury staff including licensed nurses, a registered dietitian, Chaplain, security personnel, Activity Director and Volunteer Program Coordinator
- Priority access to Grace Rehabilitation and Health Center, the Memory Support Center and rehabilitative therapies

B – Private Suite with Private Bath (rates vary according to square footage)

Small: Monthly Fee: \$120.50 per day x 31 days = \$3,735.50

Regular: Monthly Fee: \$138.00 per day x 31 days = \$4,278.00

Large: Monthly Fee: \$150.50 per day x 31 days = \$4,665.50

Monthly Fee (couple): \$210 per day x 31 = \$6,510.00

C - Two Room Suite - Living Room, Bedroom and Private Bath

Monthly Fee: \$162.00 per day x 31 days = \$5,022.00

Monthly Fee (couple): \$221.50 per day x 31 = \$6,866.50

D - Large Two Room Suite - Living Room, Bedroom, and Private Bath

Monthly Fee: \$175.00 per day x 31 days = \$5,425.00

Monthly Fee (couple): \$234.50 per day x 31 days = \$7,269.50

E - Two Room Suite - Living Room, Bedroom, Private Bath, and Balcony

Small: Monthly Fee: \$162.00 per day x 31 days = \$5,022.00

Monthly Fee (couple): \$221.50 per day x 31 days = \$6,866.50

Large: Monthly Fee: \$175.00 per day x 31 days = \$5,425.00

Monthly Fee (couple): \$234.50 x 31 days = \$7,269.50

Room rates vary depending on type of accommodations.

Short stays are available for any reason any time of year.

Simply bring your suitcase, we will provide the rest!

Trial stay: Experience the lifestyle at Cribbs Residential Center before committing to a permanent move.

Recovery: Regain your strength, confidence and independence after a hospital stay or rehabilitation before returning to your home.

Respite: When your caregiver is unavailable or on vacation, take your own and vacation at Wesbury!

Winter: Don't hibernate! Rejuvenate! Join us and enjoy a worry and hassle free winter.

The same inclusions and daily fees apply as required for a long term stay. The basic fee is charged according to the daily rate for the apartment chosen. See rates listed above. Personal Care may be added as described on page four. Services are billed according to the assessment level.



Photo above shows a furnished apartment available for a trial stay

Fee Schedule

Personal Care:

Personal Care Services such as assistance with personal hygiene, medication, supervision and reminders are available as needed. The daily charge for services is determined by the assessed level of care required.

Level One	- \$10 per day (monthly fee: 31 days x \$10 = \$310)
Level Two	- \$20 per day (monthly fee: 31 days x \$20 = \$620)
Level Three	- \$39 per day (monthly fee: 31 days x \$39 = \$1,209)
Level Four	- \$50 per day (monthly fee: 31 days x \$50 = \$1,550)
Level Five	- \$62 per day (monthly fee: 31 days x \$62 = \$1,922)

Mobility Assistance:

Regulations require additional staff to accommodate residents who need assistance to evacuate in the event of an emergency due to a physical and or cognitive limitation.

The fee for this assistance is \$20/day.

Transportation: No charge for transportation to medical appointments within 20 mile radius.

\$.50 per mile for vehicle usage and \$15 per hour for staff time.
(minimum charge is \$25)

Beauty Shop:	Permanent	\$42.00	Shampoo, set and cut	\$24.00
	Shampoo & set	\$12.00	Hair color w/shampoo & set	\$30.00
	Shampoo & blow dry	\$10.00	Color w/highlights	\$55.00
	Beard Trim	\$ 4.00	Set Only	\$10.00
	Hair cut - Women	\$12.00	Hair cut – Men	\$11.00
	Highlights/Lowlights (full head)	\$35.00	Highlights/Lowlights (per foil)	\$ 3.00
	Manicures/Pedicures	\$10.00 each or \$19.00 for both		

Guest Meals: Visitors & Guests

Breakfast	\$6.50
Dinner	9.50
Supper	7.50
Holiday Dinner	14.00

Children under 10 years of age are 1/2 price.

Shryock Guest House for Visiting Relatives/Friends:

\$50 per night; \$55 per night double

Delinquent Charge: 1.25% per month

Medical Supplies and Drugs: At resident's cost

Personal Independence and Quality Care in a Secure, Christian Setting

Frequently Asked Questions

Question: Is there an Admission Fee?

Answer: No.

Question: Do I have to sign a lease?

Answer: No. You may stay as long as you wish. You are only billed for the days you reside here.

Question: Are the apartments/rooms private?

Answer: Yes - All are private with private bath.

Question: What does the apartment consist of?

Answer: Floor plans vary. All have a private living space, bathroom and closet. Some have a living room, kitchenette and/or balcony.

Question: Do you have apartments for couples?

Answer: Yes!

Question: Can I bring my own furniture?

Answer: Yes - it is preferable that you bring your own furnishings. Wesbury can provide some furniture if needed. Furniture is provided for winter, respite and trial stays.

Question: Is Personal care assistance available?

Answer: Yes - such as support with administering medications, reminders and assistance with bathing, dressing and grooming can be added for a fee.

Question: Will I be in control of my own financial resources?

Answer: Yes - Residents or responsible parties are in control of their own financial resources.

Question: Can I leave the premises?

Answer: Yes - This is your home, you may come and go as you please.

Question: Can I bring my own vehicle?

Answer: Yes - a valid driver's license, registration and proof of insurance are required.

Question: Are pets permitted?

Answer: Yes! We permit cats, birds, and fish.

Question: Can Wesbury accommodate special diets?

Answer: Yes - There is a licensed dietitian available.



Directions to Wesbury

Traveling north or south on Interstate 79, visitors should take the Meadville exit 147A. This exit places you on a four lane highway which you will follow for approximately 1-1/2 miles before taking the Park Avenue exit into downtown Meadville. Visitors should travel straight through Meadville to the Wesbury campus. Wesbury is approximately 2-1/2 miles from the Park Avenue exit and is located on the right-hand side of the road.

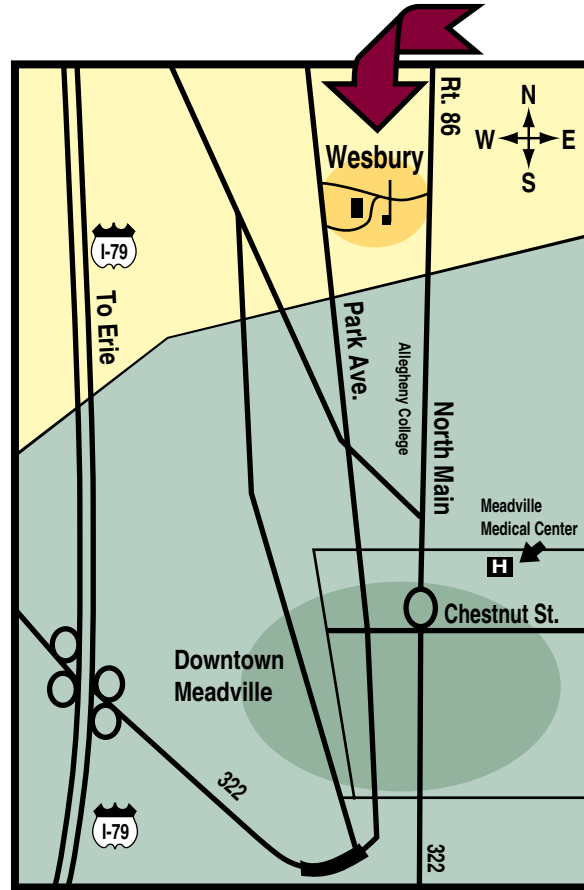

*For more information
or to schedule a tour, please contact us at
814-332-9009
Toll Free 1-877-937-2879
www.wesbury.com*

