



*Celebrating 100 Years!*

# Enhanced Living and Personal Care



## Hyatt M. and Ida M. Cribbs Residential Center

31 N. Park Avenue • Meadville, PA 16335

814-332-9009 • Toll Free 1-877-937-2879

[www.wesbury.com](http://www.wesbury.com)



*Celebrating 100 Years!*

For 100 years, Wesbury has built a strong reputation for exceeding the expectations of the Continuing Care Retirement Community experience. As a Christian based, not-for-profit organization, Wesbury is committed to providing much more than a fine collection of programs and services - we are committed to providing an enriched way of life.

*Wesbury provides individualized proactive health care and life enrichment services to assist mature adults in maintaining their independence, dignity and spiritual wholeness in a secure, Christian environment.*

*- Mission Statement -*

# Enhanced Living and Personal Care at Wesbury

Cribbs Residential Center is specifically designed for those who desire to maintain independence, but may require some assistance with daily tasks, bridging the gap between residential living and nursing care.

The attentive staff provides all dining, laundry and housekeeping services as well as transportation, security and a variety of life enrichment and fitness programs. Through participation in the local community, as well as on campus events, residents may be as active or relaxed as they choose. Residents also find comfort in knowing that additional assistance is always available. Skilled caregivers, which include licensed nurses, are on-site 24 hours every day and can assist with a wide range of personal needs such as bathing, dressing, managing medications and medical care. As the burdens and chores of daily living are lifted, residents are free to enjoy life - with choice, dignity, privacy and security.

## Community Amenities

- 110-acre private, beautifully landscaped campus
- Nearby golf courses, lakes and outdoor attractions
- Exercise room
- Wellness center
- Gift shop
- Dining options include the Neighborhood Grill Restaurant
- Library
- Free wireless internet
- Video conferencing using Skype technology
- Community room for entertainment, lectures and special events
- Beauty/barber shop
- Card rooms
- Craft/recreational room with billiards and Wii
- Three on-site Chapels
- Catered private dining room
- Guest accommodations and parking
- Nature trail
- Picnic pavilion and gazebo
- Outdoor gardening areas
- Art studio
- Sewing room
- Activities kitchen
- Wood shop
- On-site access to public transportation
- ATM
- Common kitchen and laundry room for personal use
- Pharmacy / Convenience store
- Medical Arts Building with on-site Geriatric Specialist



# Rates and Information

The following rates and inclusions apply for temporary and long term accommodations.

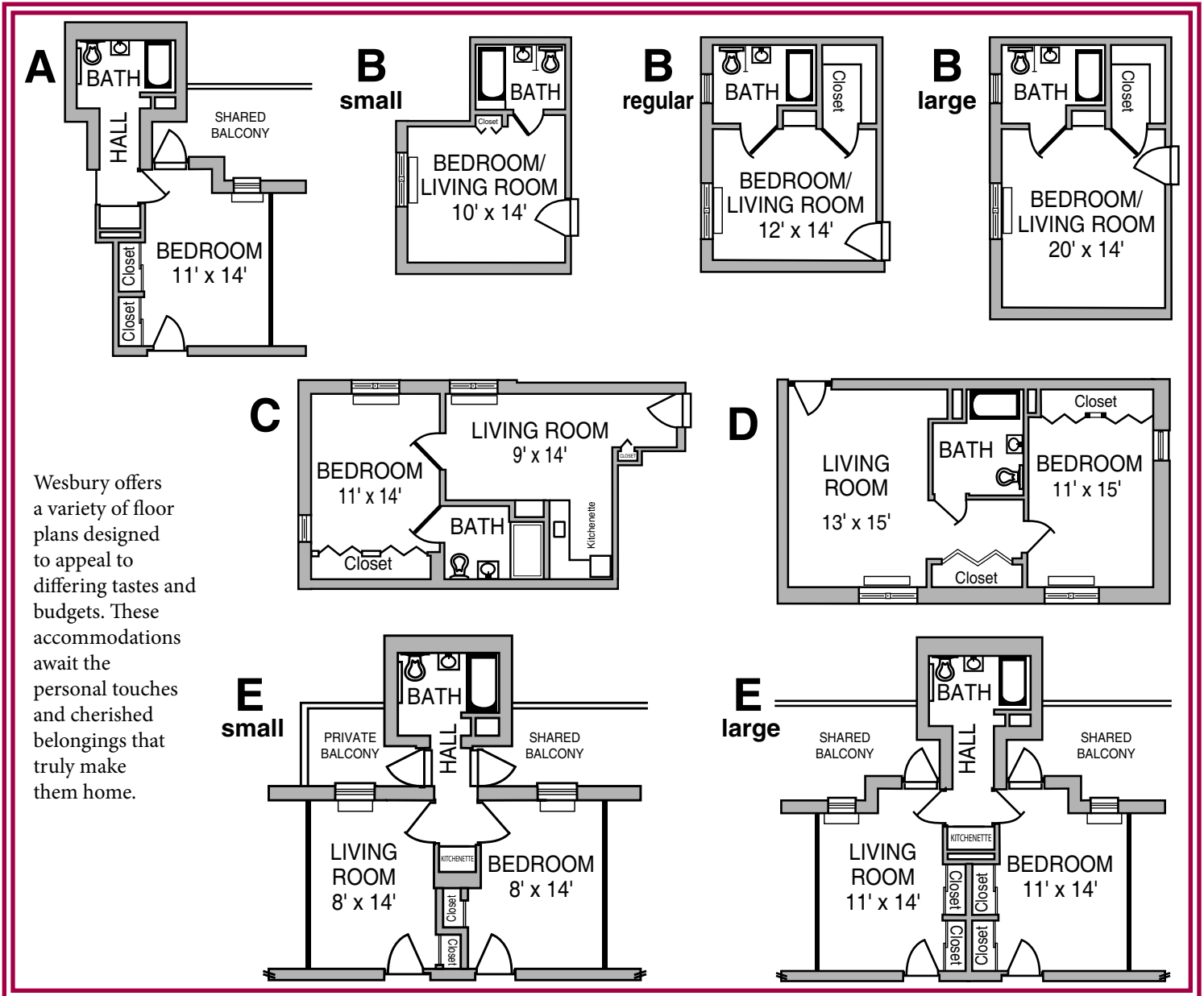

## Basic monthly fees include:

- All meals and snacks are available in our dining room and The Neighborhood Grill
- Housekeeping services
- All utilities including local telephone service
- Basic television cable service
- Free WiFi
- Complete interior and exterior maintenance
- Transportation for local medical appointments and shopping
- Linen and laundry service
- A full-time Chaplain offering spiritual programs and support
- Life enrichment and fitness programs
- Emergency response system
- Local ambulance membership
- Notary services
- Move-in coordination
- Direct-dial smoke and fire system
- Access to all Wesbury staff including licensed nurses, a registered dietitian, Chaplain, security personnel, Activity Director and Volunteer Program Coordinator
- Priority access to Grace Rehabilitation and Health Center, the Memory Support Center and rehabilitative therapies

### A – Private Suite with Shared Bath and Balcony

Monthly Fee: \$93.00 per day x 31 days = \$2,883.00

### B – Private Suite with Private Bath (rates vary according to square footage)

**Small:** Monthly Fee: \$114.00 per day x 31 days = \$3,534.00

**Regular:** Monthly Fee: \$130.00 per day x 31 days = \$4,030.00

**Large:** Monthly Fee: \$142.00 per day x 31 days = \$4,402.00\*

### C - Two Room Suite - Living Room, Bedroom and Private Bath

Monthly Fee: \$152.00 per day x 31 days = \$4,712.00\*

### D - Large Two Room Suite - Living Room, Bedroom, and Private Bath

Monthly Fee: \$165.00 per day x 31 days = \$5,115.00\*

### E - Two Room Suite - Living Room, Bedroom, Private Bath, and Balcony

**Small:** Monthly Fee: \$152.00 per day x 31 days = \$4,712.00\*

**Large:** Monthly Fee: \$165.00 per day x 31 days = \$5,115.00\*

\*For Second Person Fee Add: \$58.00 per day x 31 days = \$1,798.00

*Room rates vary depending on type of accommodations.*

## Winter, Respite and Trial Stays

In addition to long term arrangements, a variety of temporary or trial stay options are available. Consider a stay for any reason, any length of time, any time of year. Whether to enjoy a hassle free winter, to provide a break for a caregiver or to receive support when recovering from an illness, furnished apartments are offered with no minimum stay requirements. This is also an opportunity to try out the lifestyle before committing to a permanent move. **The same inclusions and daily fees apply as required for a long term stay. The basic fee is charged according to the daily rate for the apartment chosen. See rates listed above. Personal Care may be added as described on page four. Services are billed according to the assesment level.**



*Photo above shows a furnished apartment available for a trial stay*

# Fee Schedule

---

## Personal Care:

Personal Care Services such as assistance with personal hygiene, medication, supervision and reminders are available as needed. The daily charge for services is determined by the assessed level of care required.

Level One	- \$9 per day (monthly fee: 31 days x \$9 = \$279)
Level Two	- \$19 per day (monthly fee: 31 days x \$19 = \$589)
Level Three	- \$37 per day (monthly fee: 31 days x \$37 = \$1,147)
Level Four	- \$47 per day (monthly fee: 31 days x \$47 = \$1,457)
Level Five	- \$58 per day (monthly fee: 31 days x \$58 = \$1,798)

**Transportation:** No charge for transportation to medical appointments within 20 mile radius.

\$1.00 per mile for vehicle usage and \$10 per hour for staff time.  
(minimum charge is \$25)

<b>Beauty Shop:</b>	Permanent	\$40.00	Shampoo, set and cut	\$23.00
	Shampoo & set	\$12.00	Hair color w/shampoo & set	\$27.00
	Shampoo	\$ 9.00	Color w/highlights	\$50.00
	Beard Trim	\$ 4.00	Set Only	\$ 7.00
	Hair cut	\$11.00	Hair cut – Barber	\$11.00
	Highlights/Lowlights (full head)	\$30.00	Highlights/Lowlights (per foil)	\$ 2.00
	Manicures/Pedicures	\$8.00 each or \$15.00 for both		

## Guest Meals:

### Visitors & Guests

Breakfast	\$5.50
Dinner	8.50
Supper	6.50
Holiday Dinner	13.00

Children under 10 years of age are 1/2 price.

## Shryock Guest House for Visiting Relatives/Friends:

\$50 per night; \$55 per night double

**Delinquent Charge:** 1.25% per month

**Medical Supplies and Drugs:** At resident's cost

*Personal Independence and Quality Care in a Secure, Christian Setting*

# Frequently Asked Questions

**Question:** Is there an Admission Fee?

**Answer:** No.

**Question:** Do I have to sign a lease?

**Answer:** No. You may stay as long as you wish. You are only billed for the days you reside here.

**Question:** Are the apartments/rooms private?

**Answer:** Yes - Most are private with private bath. Type A apartments share a bathroom with another person, but the living area is not shared.

**Question:** Do you have apartments for couples?

**Answer:** Yes!

**Question:** Can I bring my own furniture?

**Answer:** Yes - it is preferable that you bring your own furnishings. Wesbury can provide some furniture if needed. Furniture is provided for winter, respite and trial stays.

**Question:** Is Personal care assistance available?

**Answer:** Yes - Personal care services such as support with administering medications, reminders and assistance with bathing, dressing and grooming can be added for a fee.

**Question:** Will I be in control of my own financial resources?

**Answer:** Yes - Residents or responsible parties are in control of their own financial resources.

**Question:** Can I leave the premises?

**Answer:** Yes - This is your home, you may come and go as you please.

**Question:** Can I bring my own vehicle?

**Answer:** Yes - a valid driver's license, registration and proof of insurance are required.

**Question:** Are pets permitted?

**Answer:** Yes!

**Question:** Can Wesbury accommodate special dietary requests?

**Answer:** Yes - There is a licensed dietitian available.



### Directions to Wesbury

Traveling north or south on Interstate 79, visitors should take the Meadville exit 147A. This exit places you on a four lane highway which you will follow for approximately 1-1/2 miles before taking the Park Avenue exit into downtown Meadville. Visitors should travel straight through Meadville to the Wesbury campus. Wesbury is approximately 2-1/2 miles from the Park Avenue exit and is located on the right-hand side of the road.

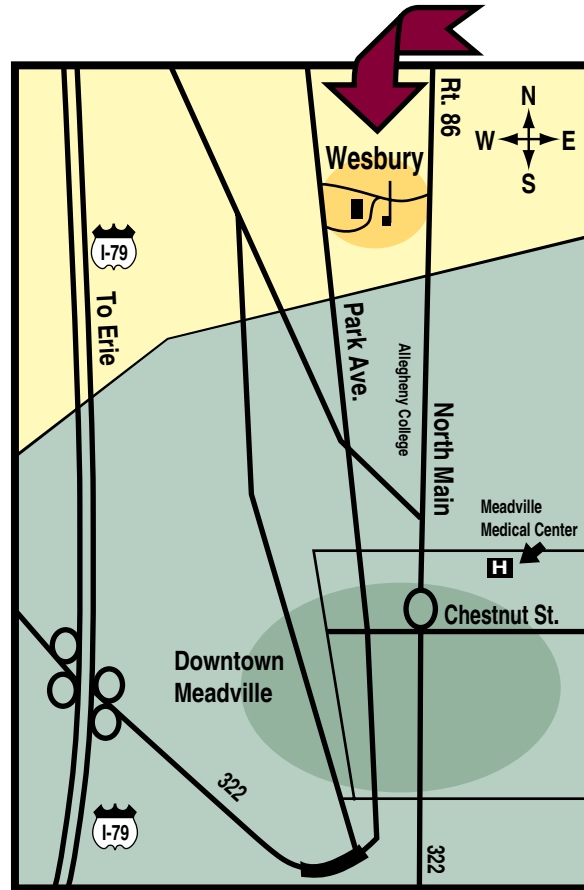

*For more information  
or to schedule a tour, please contact us at  
814-332-9009  
Toll Free 1-877-937-2879  
www.wesbury.com*

